

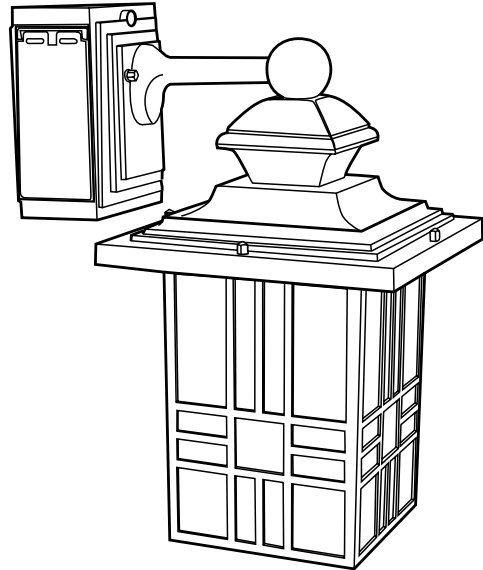

# LED WALL LANTERN with integrated GFCI outlet and photocell sensor



MODEL # 30811491  
ITEM # 15514

SPECIFICATIONS	TOOLS REQUIRED (NOT INCLUDED)
Dimensions: 24.1 cm (9.5 in) L 34.5 cm (13.6 in) D 43.7 cm (17.2 in) H  Electrical Requirements: 110-120 VAC 60 HZ Maximum Amperage: 15 A	Safety Goggles #2 Phillips Screwdriver Pliers

## PARTS

Remove fixture and mounting package from box and make sure that parts are not missing.\* (Parts are not to scale.)

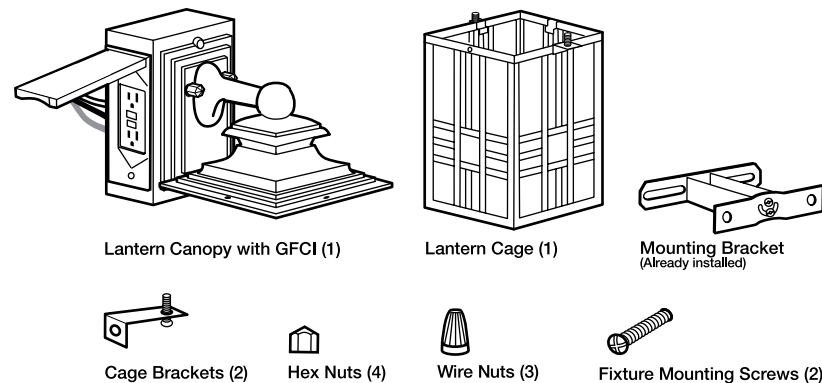

\* The OUTLET BOX is not provided. To install this fixture a standard OUTLET BOX needs to be pre-installed in the wall at the desired mounting location. Power supply wires need to be run to the OUTLET BOX providing 120 VAC of power. If an OUTLET BOX does not exist, contact a qualified electrician to have one installed.

**PLEASE READ ALL INSTRUCTIONS BEFORE ASSEMBLING  
AND USING YOUR NEW OUTDOOR WALL LANTERN.**

Thank you for purchasing this Sunbeam® LED Wall Lantern with integrated GFCI and photocell sensor.

# SAVE THESE INSTRUCTIONS

## ASSEMBLY AND INSTALLATION

DISCONNECT POWER AT CIRCUIT BREAKER.

- 1 Pull the power supply wires out from the OUTLET BOX, and attach the MOUNTING BRACKET to the OUTLET BOX, using the BRACKET MOUNTING SCREWS. (FIG. 1)

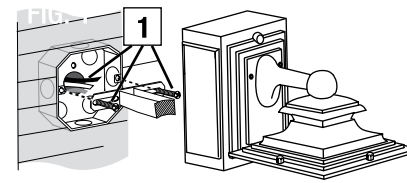

- 2 Make the wire connections using the WIRE NUTS. (FIG. 2)

- A - WHITE (neutral) SUPPLY WIRE to WHITE FIXTURE WIRE
- B - BLACK (hot) SUPPLY WIRE to BLACK FIXTURE WIRE
- C - SUPPLY GROUND WIRE to FIXTURE GROUND WIRE

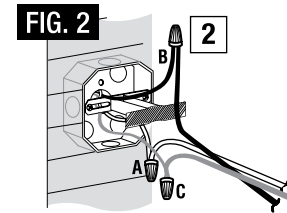

- 3 Place the WALL PLATE over the OUTLET BOX, making sure the FIXTURE MOUNTING SCREWS feed through the holes on the WALL PLATE. (FIG. 3)

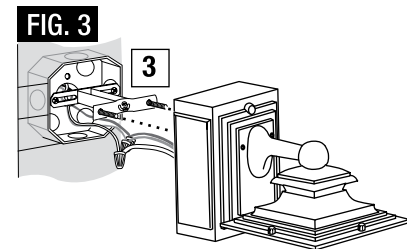

- 4 Adjust the FIXTURE MOUNTING SCREWS until they protrude out from the WALL PLATE 6 mm (¼ in). Remove the WALL PLATE and secure the position of the FIXTURE MOUNTING SCREWS by tightening the HEX NUTS against the MOUNTING BRACKET. (FIG. 4)

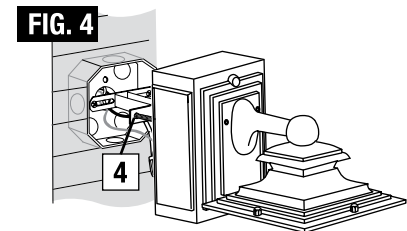

- 5 Carefully tuck all the WIRES and WIRE NUTS into the OUTLET BOX. Place the WALL PLATE back onto the FIXTURE MOUNTING SCREWS, and secure it into place using the HEX NUTS. (FIG. 5)

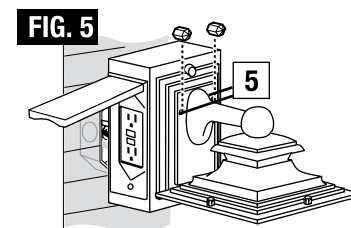

- 6 Remove bolts from CAGE, install CAGE BRACKETS onto CAGE and tighten bolts properly. (FIG. 6)

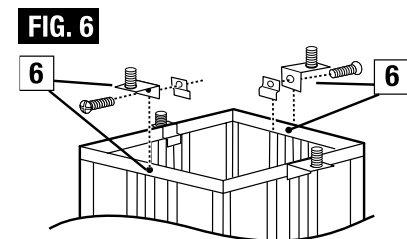

- 7 Attach the CAGE to the LANTERN CANOPY with 4 HEX NUTS provided (FIG. 7)

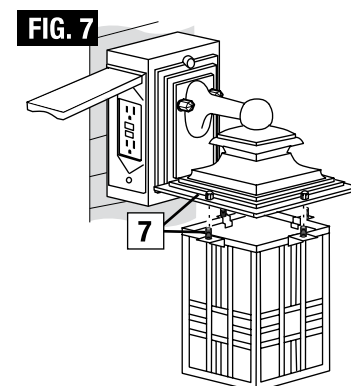

- 8 After installing the fixture, caulk the upper two thirds of the WALL PLATE to the mounting surface. Leave the bottom one third un-caulked to allow for drainage of any water that might leak into the enclosure. The manufacturer recommends a non-drying exterior caulking material. A good example is a clear silicone rubber sealant for exterior use.

- 9 RESTORE POWER AT THE CIRCUIT BREAKER. Turn on the wall switch.

This fixture has a photocell light control located on the front of the canopy. Wall switch should always be on. The LED lights will turn on when the ambient light around diminishes to a nighttime light level. The lights will remain on until the ambient light has risen back to daylight level. Avoid installing the fixture near nighttime light sources, such as streetlights or other light fixtures, which might prevent the light from turning on.

## PRODUCT MAINTENANCE

To clean the fixture, disconnect the power to the fixture by turning off the circuit breaker or removing the fuse box. Wait a few minutes for the fixture to cool down. Use a dry or slightly dampened clean cloth (use clean water, never a solvent) to wipe the glass and surface of the fixture.

Do not use any cleaners with chemicals, solvents or harsh abrasives. If necessary, use a mild soap to clean any dirt or stains.

## TROUBLE SHOOTING

Please try the solutions below before contacting our customer service or returning product to store.

SYMPTOM	POSSIBLE CAUSE	SOLUTION
Lights do not come on at all.	Wall switch and/or circuit breaker is off.	Turn on wall switch and/or circuit breaker.
	Incorrect or loose wire connection.	Access outlet box and fix wire connections.
	Light from another light source, such as a streetlight or another light fixture, is shining on top of the photocell.	Eliminate the light source or move fixture to another location.
Lights stay on throughout the day (or late into the day).	Lantern is installed during daytime and photocell sensor is not activated.	Wait until dusk and check if light will be on or cover photocell sensor with your thumb to test.
	Fixture may be installed in a shaded area, such as under a porch or an eave, and not enough light is shining onto photocell during the daytime.	Relocate fixture to a well-lit area.
Fuse blows or circuit breaker trips when light is turned on.	Crossed wires or power wire is grounding out.	Access outlet box and fix wire connections.

**CAUTION:** ALL ELECTRICAL CONNECTIONS MUST BE IN ACCORDANCE WITH LOCAL AND NATIONAL ELECTRICAL CODE (N.E.C.) STANDARDS. IF YOU ARE UNFAMILIAR WITH PROPER ELECTRICAL PRACTICES, OBTAIN SERVICES OF A QUALIFIED ELECTRICIAN. TURN OFF THE MAIN POWER AT CIRCUIT BREAKER BEFORE INSTALLING FIXTURE, IN ORDER TO PREVENT POSSIBLE SHOCK. BEFORE CLEANING FIXTURE, TURN OFF POWER AND ALLOW SEVERAL MINUTES FOR THE FIXTURE TO COOL DOWN. WITH SILICONE CAULKING COMPOUND, CAULK COMPLETELY AROUND WHERE BACK CANOPY MEETS THE WALL SURFACE TO PREVENT WATER SEEPING INTO THE JUNCTION BOX.

**IMPORTANT NOTICE:** IN ORDER TO AVOID THE RISK OF ELECTRIC LEAKAGE BY WATER GOING INTO THE FIXTURE, THE RUBBER GASKET MUST BE INSTALLED WITH THE NUTS WHILE TIGHTENING THE SCREWS.

**WARNING:** IN ORDER TO AVOID WATER ACCUMULATION, DO NOT REVERSE THE DIRECTION OF THE CAGE AS SHOWN IN FIGURE 6.

**CAUTION:** USED FOR OUTDOOR AND WALL MOUNT ONLY.

**If you encounter any problems, please do not return to the store.**  
Please contact our customer service toll free line at  
**1-877-383-6399** (8:30 am – 17:30 pm E.S.T.) Monday - Friday

**LIMITED WARRANTY:** This product is guaranteed to operate a minimum of 3 years from the original date of purchase. If, under normal use and for the full time period, your product fails to operate, please return it to: Quality Control Dept., L'Image Home Products Inc., 1175 Place du Frère-André, Montreal, Quebec, Canada H3B 3X9 (with your original proof of purchase receipt) and we will refund it. This warranty is considered void if the product fails from misuse.

© 2014 Sunbeam Products, Inc. doing business as Jarden Consumer Solutions. All rights reserved. SUNBEAM® logo is a registered trademark of Sunbeam Products, Inc. used under license. Distributed by L'Image Home Products Inc., Montreal, Canada H3B 3X9. LHP921-022814

Visit our website: [www.limagehomeproducts.com](http://www.limagehomeproducts.com)

